



SL22F THRU SL210F

Reverse Voltage - 40 to 60 Volts Forward Current - 2.0 Ampere

SURFACE MOUNT SCHOTTKY BARRIER DIODES

Features

- ◆ V@Á |æ cãÁ æã æ^ Áæã |ã • ÁM) à^! , |æ! • Áæã |æã |^ Á
Øæ { æããc Á |æ • æãæã } Á | XEÁU[PÜEã {] |æã c
- ◆ Qã^æÁ |Á |ã c^ãã& ãã[æã
- ◆ U] ^} ÁR } &ã } &ã Á
- ◆ Š |, Á^ç^! • ^Á^æ æ^ Pã @Á |, æãÁ ~ ! * ^Á& ~ !! ^} á
- ◆ &ã æããc Pã @Á {] ^!æ !^Á |ã^!ã * Á ~ æã c^ã
- ◆ G € B^Á^& |ã • Áæã |ã æã Á

SMAF

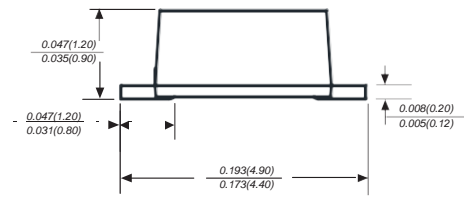
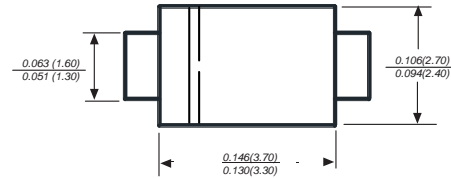

Dimensions in inches and (millimeters)

Mechanical Data

- Case: UT Ø molded plastic body
- Terminals: Solderable per MIL-STD-750, Method 2026A
- Polarity: Polarity symbol marking on body
- Mounting Position: Any
- Weight: 0.00€J ounce, 0.0G7 grams

Maximum Ratings And Electrical Characteristics

Ratings at 25°C ambient temperature unless otherwise specified.

Single phase half-wave 60Hz, resistive or inductive load, for capacitive load current derate by 20%.

| Parameter | SYMBOLS | MDD SL22F | MDD SL24F | MDD SL26F | MDD SL28F | MDD SL210F | UNITS |
|---|-----------------|-------------|-----------|-----------|-------------|------------|---------------------------|
| Marking Code | | | | | | | |
| Maximum repetitive peak reverse voltage | V_{RRM} | 14 | 28 | 42 | 56 | 70 | |
| Maximum RMS voltage | V_{RMS} | 20 | 40 | 60 | 80 | 100 | V |
| Maximum DC blocking voltage | V_{DC} | 20 | 40 | 60 | 80 | 100 | V |
| Maximum average forward rectified current at TL (see fig. 1) | $I_{(AV)}$ | 2.0 | | | | | A |
| Peak forward surge current 8.3ms single half sine-wave superimposed on rated load (JEDEC Method) | I_{FSM} | 50 | | | | | A |
| Maximum instantaneous forward voltage at 2.0A | V_F | 0.45 | | 0.5 | 0.7 | | V |
| Maximum DC reverse current $T_A=25^\circ\text{C}$ at rated DC blocking voltage $T_A=125^\circ\text{C}$ | I_R | 0.5 10.0 | | | 0.2 5.0 | | mA |
| Typical junction capacitance (NOTE 1) | C_J | 220 | | | 180 | | pF |
| Typical thermal resistance (NOTE 2) | $R_{\theta JA}$ | 90.0 | | | | | $^\circ\text{C}/\text{W}$ |
| Operating junction temperature range | T_J | -55 to +125 | | | -55 to +150 | | $^\circ\text{C}$ |
| Storage temperature range | T_{STG} | -55 to +150 | | | | | $^\circ\text{C}$ |

Note: 1. Measured at 1MHz and applied reverse voltage of 4.0V D.C.
2. P.C.B. mounted with 0.2x0.2" (5.0x5.0mm) copper pad areas



Typical Characteristics

AVERAGE FORWARD RECTIFIED CURRENT, AMPERES

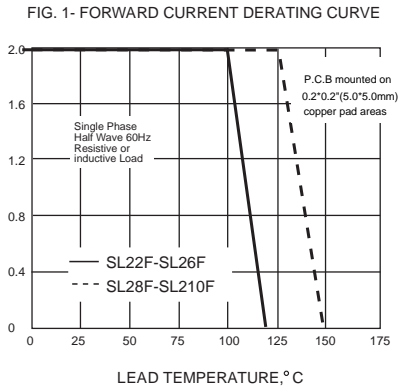

PEAK FORWARD SURGE CURRENT, AMPERES

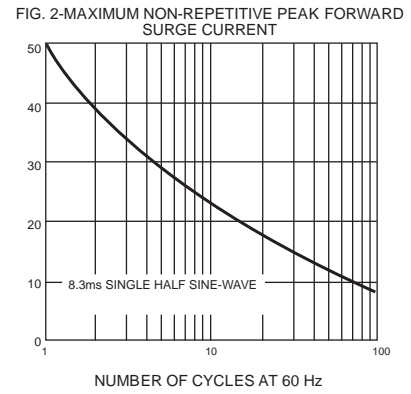

INSTANTANEOUS FORWARD CURRENT, AMPERES

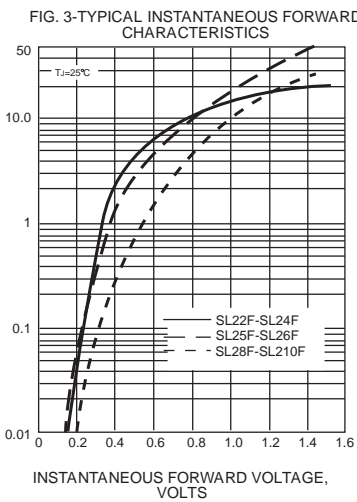

INSTANTANEOUS REVERSE CURRENT, MILLIAMPERES

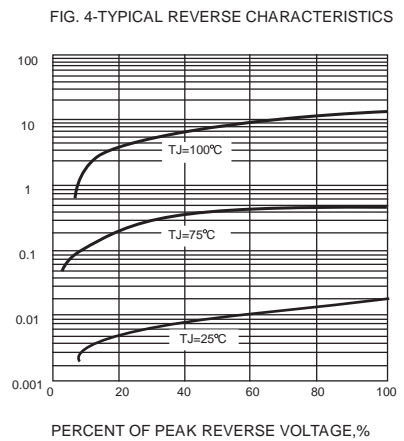

JUNCTION CAPACITANCE, pF

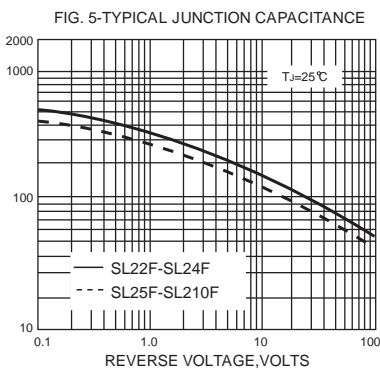

TRANSIENT THERMAL IMPEDANCE, °C/W

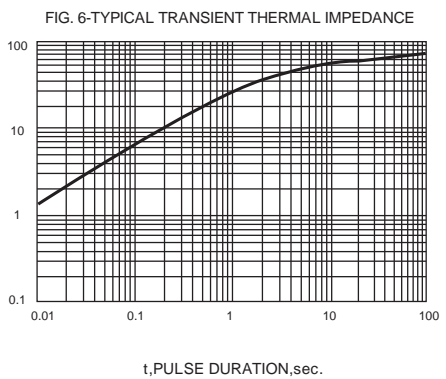

The curve above is for reference only.



SL22F THRU SL210F

Reverse Voltage - 40 to 60 Volts Forward Current - 2.0 Ampere

Packing information

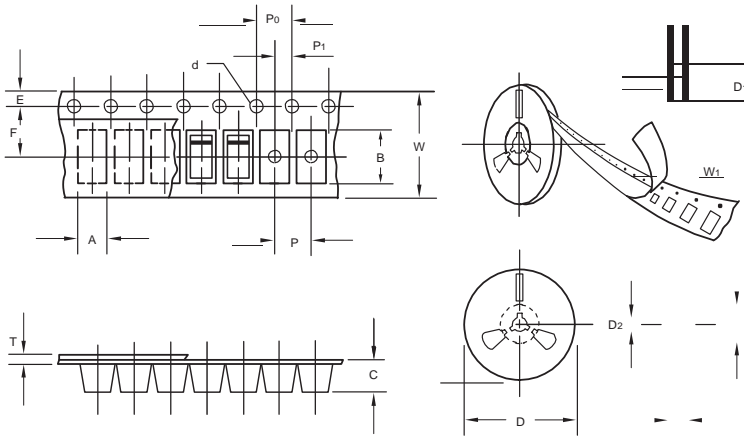

unit:mm

| Item | Symbol | Tolerance | SMAF |
|--------------------------|--------|-----------|--------|
| Carrier width | A | 0.1 | 2.80 |
| Carrier length | B | 0.1 | 4.75 |
| Carrier depth | C | 0.1 | 1.42 |
| Sprocket hole | d | 0.05 | 1.50 |
| 7" Reel outside diameter | D | 2.0 | 178.00 |
| 7" Reel inner diameter | D1 | min | 54.40 |
| Feed hole diameter | D2 | 0.5 | 13.00 |
| Sprocket hole position | E | 0.1 | 1.75 |
| Punch hole position | F | 0.1 | 5.05 |
| Punch hole pitch | P | 0.1 | 4.00 |
| Sprocket hole pitch | P0 | 0.1 | 4.00 |
| Embossment center | P1 | 0.1 | 2.00 |
| Overall tape thickness | T | 0.1 | 0.30 |
| Tape width | W | 0.3 | 8.00 |
| Reel width | W1 | 1.0 | 12.30 |

Note: Devices are packed in accordance with EIA standard RS-481-A and specifications listed above.

Reel packing

| PACKAGE | REEL SIZE | REEL (pcs) | COMPONENT SPACING (m/m) | BOX (pcs) | INNER BOX (m/m) | REEL DIA, (m/m) | CARTON SIZE (m/m) | CARTON (pcs) | APPROX. GROSS WEIGHT (kg) |
|---------|-----------|------------|-------------------------|-----------|-----------------|-----------------|-------------------|--------------|---------------------------|
| SMAF | 7" | 3,000 | 4.0 | 6,000 | 210*208*203 | 178 | 400*265*400 | 120,000 | 10.0 |

Suggested Pad Layout

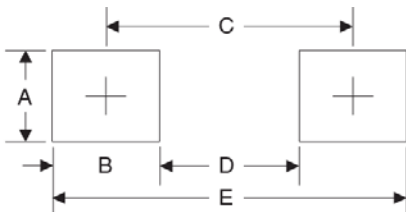

| Symbol | Unit (mm) | Unit (inch) |
|--------|-----------|-------------|
| A | 1.8 | 0.071 |
| B | 1.6 | 0.063 |
| C | 3.8 | 0.150 |
| D | 2.2 | 0.087 |
| E | 5.4 | 0.213 |